



myAir™

myAir: Your sleep therapy companion

Start therapy, stay on track, support healthy sleep habits



Download today



Getting started with myAir is easy

» **Before appointment:** Create and activate your myAir account.

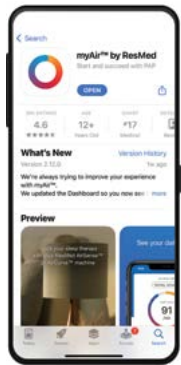

- ① **Download the myAir by ResMed app**
Scan the QR code below using your smartphone camera or download from the [App Store™](#) or [Google Play™](#) store



Scan me!

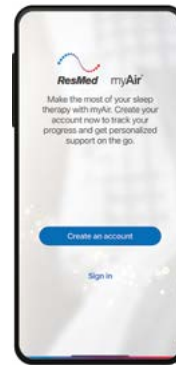

- ② **Open the app**

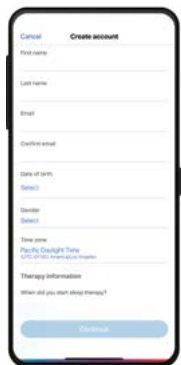

- ③ **Create an account**
- Select location (United States)
 - First, last name
 - Email, confirm email
 - Date of birth
 - Gender
 - Time zone
 - Pre-sleep therapy questions (optional)

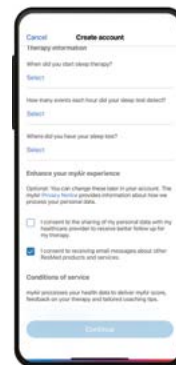

- ④ **Scroll down to review and complete consents**
- Read and understand material
 - Check consent for ResMed to share information about you with your healthcare provider to help you better manage your treatment (recommended)
 - Check consent to be informed about ResMed products and services (recommended)

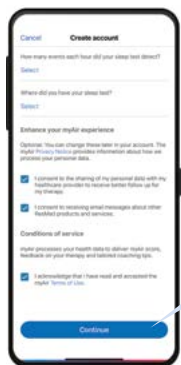

- ⑤ **Click the Continue button**

Conditions of service

myAir processes your health data to deliver myAir score, feedback on your therapy and tailored coaching tips.

I acknowledge that I have read and accepted the myAir Terms of Use.

Continue

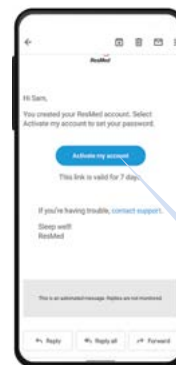

- ⑥ **Check your email**
- **Activate your account** by clicking the link in the email from ResMed (if you don't see the email, check your spam or junk folder)
 - Enter and confirm password
 - Please bring your smartphone with the app already downloaded to your setup appointment

Activate my account



» **During appointment:** Enter health information, CPAP machine and mask.



① **Sign in to the myAir app**
Enter your email address and password



② **Enter health information**
Answer a few health questions to personalize your experience



③ **Select your machine**
The clinician doing your setup will let you know which machine you'll be getting—wait for this information before you select your machine



4a **For Air11™ machines**
1. Add CPAP machine
Enter the 4-digit key displayed on the Air11 touchscreen to complete Bluetooth® pairing**
2. Add mask
Select brand, model and cushion type (if applicable)
3. Select "Get started" to follow steps for Personal Therapy Assistant† to get help with setup (Machine setup, Mask setup, Test Drive†)



4b **For Air10™ machines††**
1. Add CPAP machine
Enter 11-digit serial number (on back of machine)
Enter 3-digit device number (on back of machine)
2. Add mask
Select brand, model and cushion type (if applicable)

Start using myAir

Starting the night after setting up your myAir account, access your:

- Daily sleep score
- History to track progress
- Helpful videos
- Therapy tips

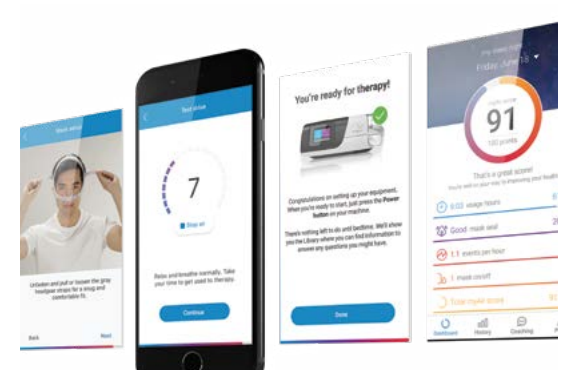

All of these features can help you get comfortable and succeed with your therapy. Be sure to check your myAir score daily to see your progress.



Visit ResMed.com/myAirApp to learn more.

* The myAir by ResMed app is available in English and Spanish in the US.

† Some features of myAir are only available in the myAir app and with Air11 devices.

** Requires Bluetooth to be turned on in smartphone settings.

†† ResMed myAir is currently not available when using AirSense 10 and AirCurve 10 Card-to-Cloud (C2C) machines.

Distributed by ResMed Corp, 9001 Spectrum Center Boulevard, San Diego, CA 92123 USA. (858) 836-5000 or (800) 424-0737 (toll-free). See ResMed.com for other ResMed locations worldwide. Air10, Air11, AirCurve, AirSense and myAir are trademarks and/or registered trademarks of the ResMed family of companies. Google Play is a trademark of Google LLC. Apple and App Store are trademarks of Apple Inc. The Bluetooth® word mark and logos are registered trademarks owned by Bluetooth SIG, Inc and any use of such marks by ResMed is under license. Specifications may change without notice. For patent and other intellectual property information, see ResMed.com/ip. © 2025 ResMed. 10112667/4 2025-01